

# SMART STEAM TRAP

## MODEL SVT™ UNI

### Description

The SMART SVT™ UNI is a universal connector venturi steam trap intended to work as a distribution (drip leg) steam trap for draining condensate from main steam lines and as a trace heating steam trap to drain condensate from trace heating lines. The trap has integrated strainers and a removable venturi insert. The SVT UNI model steam trap comes in 3 standard sizes: standard, medium, and large capacity, and it can be mounted on most of the 2 bolt quick-release universal connector bases. For additional capacity changes outside the 3 standard sizes, the trap can be resized with optional venturi inserts for extra small or extra-large capacity conditions. The body of the steam trap does not have to be removed from the line for maintenance purposes. The venturi insert and strainers can be simply accessed via the top and bottom caps. SMART SVT™ UNI model steam traps also come with an integrated blowdown valve for periodic cleaning of the bottom filter.

### Sizes and Connections

A universal connector using 2 bolts

### Pressure / Temperature Limits

PMA (Maximum Allowable Pressure) 100 bar g (1450psi g)  
 TMA (Maximum Allowable Temperature) 400° C (750°F)  
 PMO (Maximum Operating Pressure) 62 bar g (899 psig)

### Optional Extras

Closed bottom cap.  
 Universal connector base.  
 Extra-large and small size orifice to resize traps outside standard capacity range.

### Guarantee

20-year product guarantee as per standard terms and conditions.



### Benefits

1. No moving parts to fail
2. All stainless steel construction; 20 to 30-year life expectancy
3. Wide range of capacities
4. 20-year performance and materials warranty
5. Permanent up to 20-30% energy reduction; 1-2-year ROI typical
6. Fast assembly time, secured with just 2 screws
7. Integrated strainer system
8. Top and bottom cap for easy access to strainers
9. Inverted nozzle to deflect blockages
10. Can be installed in any orientation
11. Supplied with sizing and engineering services
12. Replaceable Venturi inserts for precise sizing
13. Integrated blowdown valve for strainer cleaning

### CAPACITIES - Condensate loads (kg/hr) at saturated condensate temperature

Model	Differential Pressure (BARG)													
	1	2	3	4	5	6	7	8	9	10	15	20	25	30
SVT-UNI-S	21	28	33	39	43	48	52	56	59	63	77	90	100	109
SVT-UNI-M	47	62	75	87	98	107	116	124	132	141	173	201	225	246
SVT-UNI-L	90	119	144	166	186	204	221	237	253	267	330	383	428	467

\* When condensate is cold during the system startup, the same orifice will discharge capacity of 3 times more compared to load at the saturated condensate temperature.

\* Capacities in the chart is for hot condensate at the saturated condensate temperature.

\* Venturi steam trap works on constant discharge principle and discharging condensate as it forms ongoingly, therefore, a safety factor should not be put larger than 1.5 for distribution and trace heating traps.

SMART Valves Inc.

USA Division: +1 833 775 7888

EU Division: +32 38081549

info@smartvalvesinc.com



SMART™  
VALVES

SMART STEAM TRAP™

RELIABILITY SIMPLICITY SUSTAINABILITY

# SMART STEAM TRAP

**MODEL**  
**SVT™**  
**UNI**

## Assembly

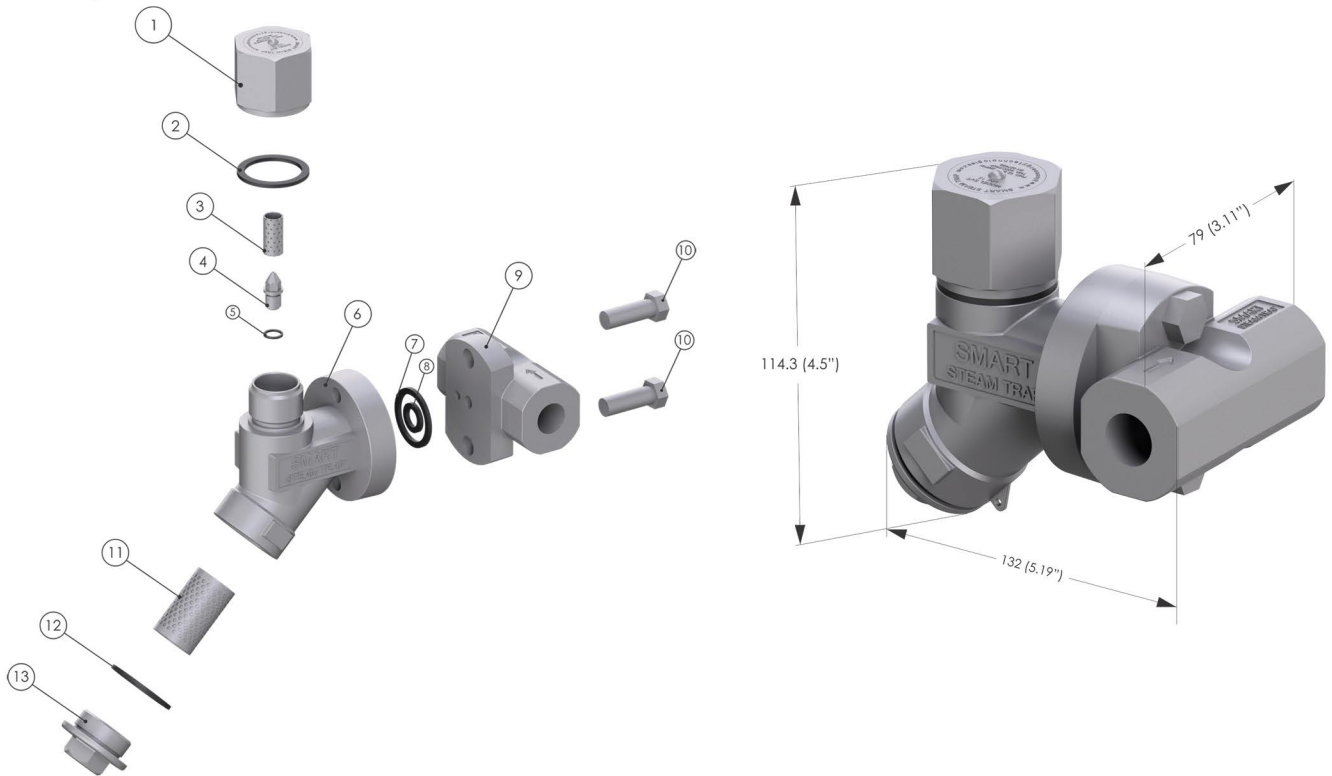

## Dimensions and Weights

Size	Connection	L	H	W	Weight
Universal	Universal 2 bolt	132 (5.19")	114.3(4.5")	79 (3.11")	2.25lbs/1kg

## Material

1	Top Cap	ASTM A 351-CF3M
2	Top Gasket	Graphite
3	Secondary Strainer	316L Stainless Steel
4	Venturi Insert	316L Stainless Steel
5	Venturi Insert Gasket	Pranit
6	Universal Adapter Base	ASTM A 351-CF3M
7	Gasket large	Inox Graphite
8	Gasket small	Inox Graphite
9	Universal Adapter Base	ASTM A 351-CF3M
10	Screw M10x35	316L Stainless Steel
11	Primary Strainer	316L Stainless Steel
12	Bottom Gasket	Graphite
13	Bottom Cap	ASTM A 351-CF3M

## Torque Settings

1	TopCap	80Nm
2	StrainerCap	80Nm
3	Removable VenturilInsert	10Nm

SMART Valves Inc.

USA Division: +1 833 775 7888

EU Division: +32 38081549

info@smartvalvesinc.com



**SMART™**  
**VALVES**

**SMART STEAM TRAP™**

RELIABILITY SIMPLICITY SUSTAINABILITY